

Weatherproof IR Camera operating instruction

DEMENSIONS

Before attempting to connect or operate this product, please read these instructions carefully and save this manual for future use.

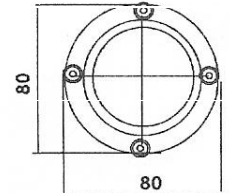
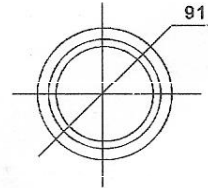
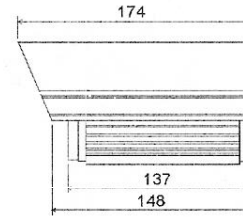

External dimensions unit: mm

	CAUTION RISK OF ELECTRIC SHOCK DO NOT OPEN	
<p>CAUTION: TO REDUCE THE RISK OF ELECTRIC SHOCK, DO NOT REMOVE COVER (OR BACK). NO USER-SERVICEABLE PARTS INSIDE. REFER SERVICING TO QUALIFIED SERVICE PERSONNEL</p>		

CAUTION FOR SAFE OPERATION

1. Be sure of power supply at $DC12V \pm 1V$.
2. Connect cables according to instruction. Wrong connection may cause malfunction and/or damage to the camera.
3. Do not expose lens directly to the sunlight or dazzling object. CCD can be damaged.
4. Do not install at extreme warm or cold place.
(Recommended operation: $-20^{\circ}C \sim 50^{\circ}C / -4^{\circ}F \sim +122^{\circ}F$)

FEATURES

1. IR LED: 54 unit infrared LEDs. IR LEDs turn on automatically in dark (lower than 1 lux)
2. IP55 Standard. For any harsh environment.
3. Water, dust and crush resistant glass coating make sure of clear and vivid image before you.
4. Use special material to isolate ultra-violet. Ensure of long time and stable working.

SPECIFICATIONS

TV system	PAL/NTSC	
Image Sensor	1/3 inch SONY CCD	
Sync System	Internal	
Mini Illumination	1 Lux	5600°K
	0Lux	(IR ON)
Resolution	480 TV Lines	
White Balance	Mode	AUTO
	Range	3200 ~ 10000°K
Gain control	Auto	
S/N Ratio	>50Db	
Electronic Shutter	1/50~1/12,000 sec.	
Auto Iris	A.E.S.	
Video out	Composite output 1.0V p-p at 75 ohm	
Gamma Correction	0.45	
Working Temp.	$-20^{\circ}C$ TO $50^{\circ}C$	
Lens	3.5~8/6/8/12/16mm	
Working Plvo.	All weatherproof	
IR range	40M 35°	
Power Supply	DC12V±1V/300mA	

* Design and specifications are subject to change without notice.

Do not attempt to disassemble or repair yourself.
Please refer all servicing to qualified service personnel. !